

DOMAINE DE
FONTENILLE

DOMAINE DE FONTENILLE



DOMAINE DE FONTENILLE

IN THE HEART OF PROVENCE

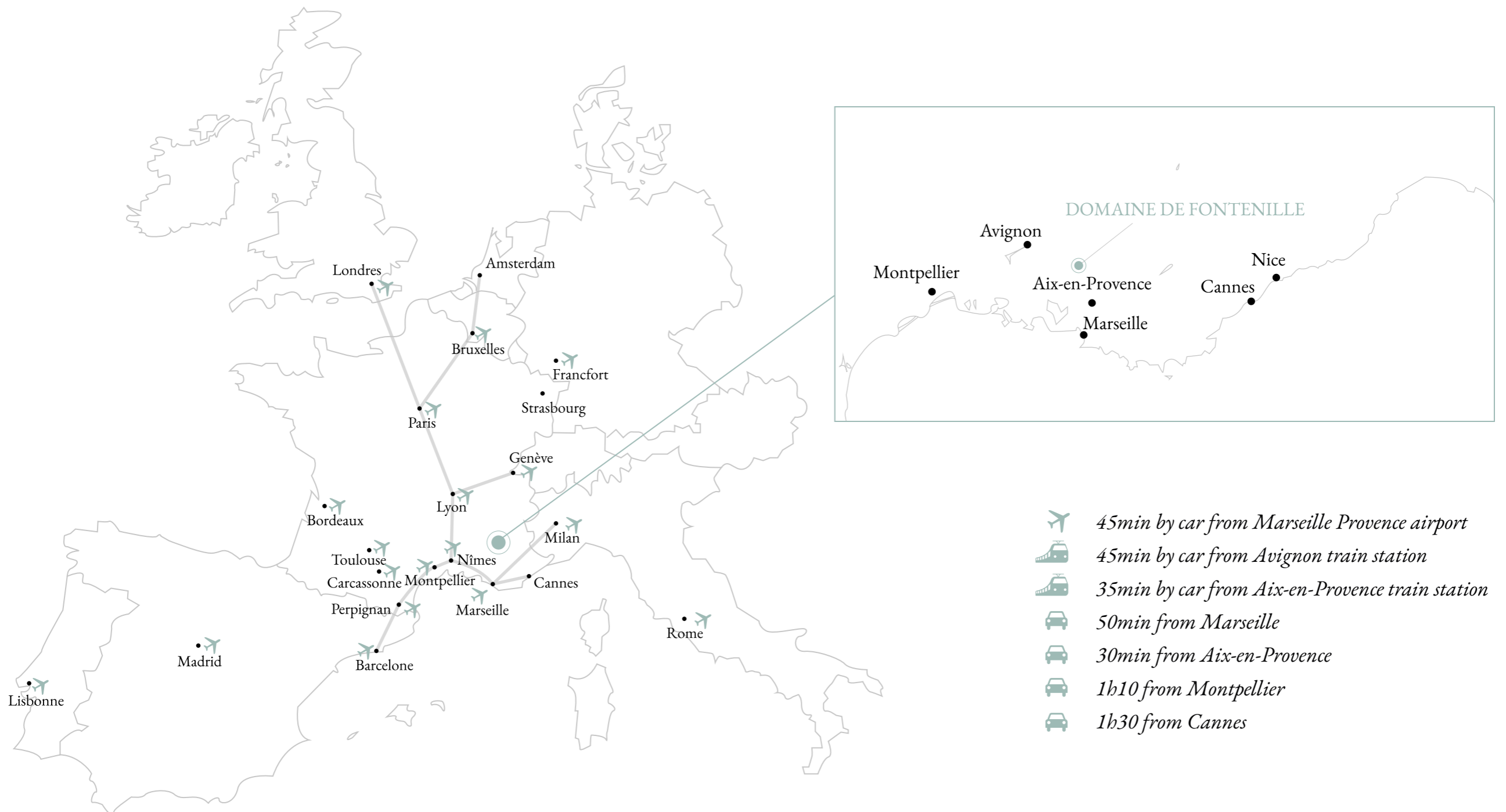

DOMAINE DE FONTENILLE

IN THE LUBERON REGIONAL NATURE PARK

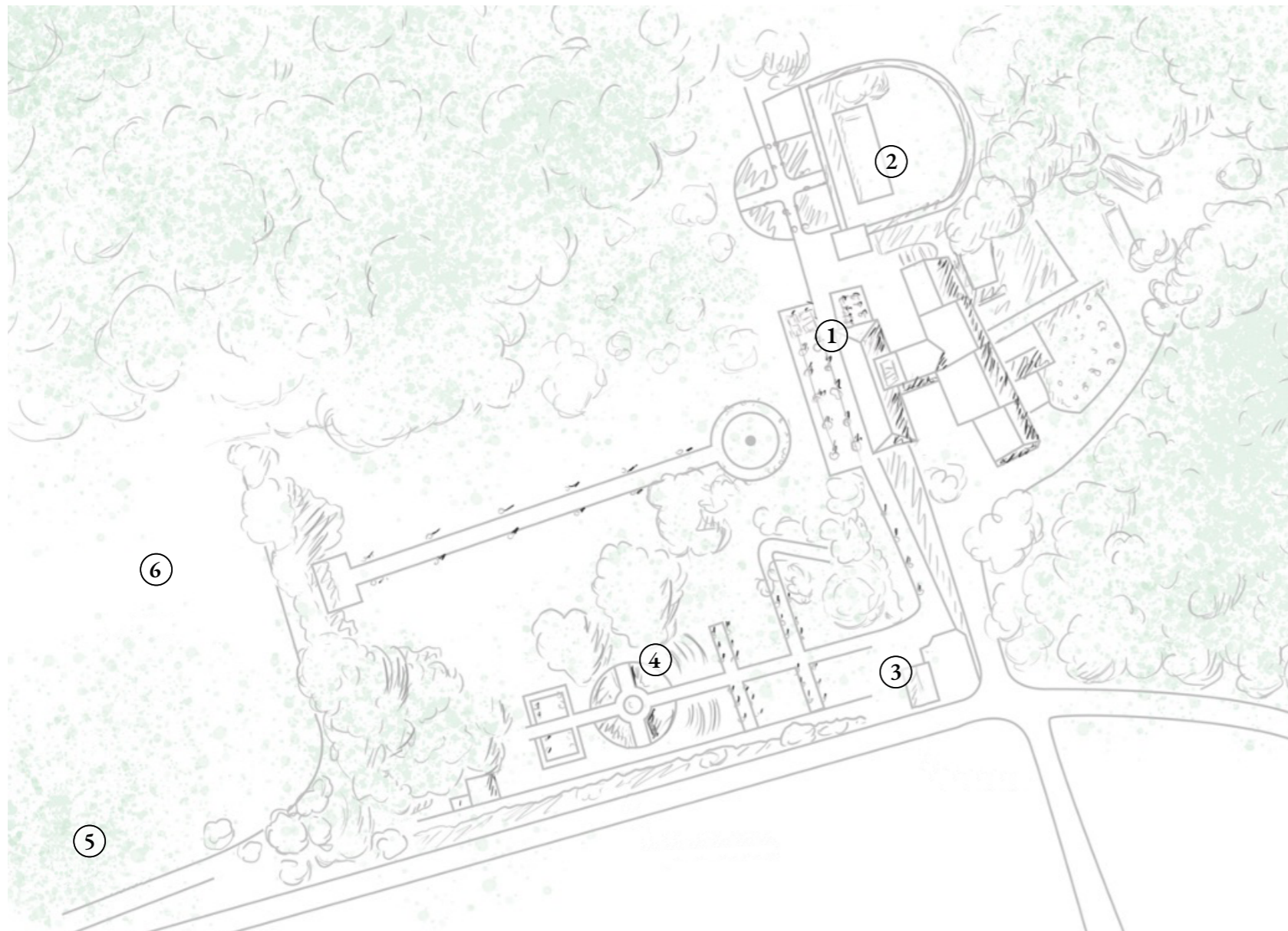

① Bastide ② Swimming pool ③ Lavoir ④ Garden ⑤ Vineyard ⑥ Vegetable garden



19 KEYS

- 16 rooms
- 2 suites
- 1 apartment



2 RESTAURANTS

- *Le Champ des Lunes*
1 Michelin star - 40 seatings
- *La Cuisine d'Amélie, Michelin*
Gourmet Bistro - 80 seatings



1 SWIMMING POOL

- *Outdoor and heated pool from April to mid-October*



1 VINEYARD

- 39 hectares
- 3 cuvées
- *White, rosé and red organic wines*



1 WELLNESS AREA

- 1 individual treatment room
- 1 double treatment room
- 1 outdoor treatment room
- 1 hammam

DOMAINE DE
FONTENILLE



DOMAINE DE FONTENILLE

KEY POINTS



DOMAINE DE FONTENILLE

A luxury hotel designed as a family house.

A country house built between the end of the 16th century and the beginning of the 19th century with 39 hectares of vines.

A wine estate in activity for 400 years.

A unique place opening onto a landscaped park with majestic plane trees and cedars.



GEOGRAPHIC LOCATION

45min away from Marseille Provence airport.

45min away from Avignon train station.

35min away from Aix-en-Provence train station.

50min away from Marseille.

30min away from Aix-en-Provence.



A NATURAL PRESERVED ENVIRONMENT

In the heart of Provence, in the Luberon regional natural park, facing the Sainte-Victoire mountain and opening onto the Durance Valley.

7min away from Lourmarin, fief of Albert Camus.

30min away from Aix-en-Provence and from the Sainte-Victoire mountain dear to Paul Cézanne.

40min away from Gordes, one of the most beautiful villages in France offering a unique panorama over the Luberon.

50min away from Isle-sur-la-Sorgue, the Venice of the Luberon, famous for its canals and antique shops.



A WINDOW ON THE LUBERON

19 unique rooms and suites facing the park.

Price range from 300€ to 650€ in high season for a surface area from 25 to 73 sq m.

An average stay in 2020 of 2 nights.

KEY POINTS



WELLNESS AND RELAXATION

A spa with a hammam and massage rooms.

Susanne Kaufmann natural protocols created from precious natural oils and pure unprocessed products.

A heated outdoor swimming pool and a fitness room.

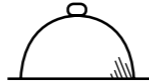

GASTRONOMY

A cuisine combining authenticity and highlighting regional products.

*A gourmet restaurant 1 * Michelin, Le Champ des Lunes, directed by Chef Michel Marini.*

A gourmet bistro, La Cuisine d'Amélie, with simple cuisine but inventive around flagship products of the region.

A permaculture vegetable garden, the main supplier to our restaurants.

Local sourcing combining seasonal products and organic farming.



EXPERIENCES

A real immersion in the heart of Provençal nature to savor the time, the beauty and the benefits of nature.

Gastronomic experiences and oenological: initiation to tasting, vineyard walk and picnic, master assembler, harvest mornings...

Sports experiences: bike rides, canyoning, canoeing, hiking in the Sainte Victoire...

Visit of the surroundings: discovery Aix-en-Provence, Mont Luberon and the typical neighboring villages.



AFFILIATIONS / GDS

*Relais & Châteaux
Travel Leaders / Internova
Mr & Mrs Smith*

*Amadeus (1A) - MRSDFO
Sabre (AA) - 305008
Galileo / Apollo (UA) - F6500
Worldspan (1P) - MRSDD*